

Model BE-950

LOW COST BEAM ROBOTS FOR PRESSES UP TO 850 TON

The BE series robots are simple pick-and-place small beam robots that are designed for applications where a sprue picker could normally do the job, but increased flexibility of the part release position is required. Most pickers swing out from the mold and drop the part from a relatively high position. Because the BE series have a horizontal beam design the arm can be lowered outside of the press where the part can be dropped directly onto a belt conveyor or table. This robot also offers the benefit of multiple-drop locations.

HAND-HELD CONTROL FOR FAST, EASY OPERATION

The BE series is pneumatically driven on the vertical and kick strokes with an AC electric drive on the horizontal stroke. Larger models can handle payloads up to 44 lbs {20 kg}.

This small beam robot is equipped with an easy-to-use, hand-held control. Any changes in program sequencing or robot positioning can be achieved in just a few seconds.

To reduce the total footprint of the BE robot the control has been conveniently integrated into the horizontal beam.

■ Fast take-out time

Thin wrist design and quick take-out times mean the mold open time is minimal to accommodate fast cycles.

■ Flexible part placement

The 90° wrist rotation allows parts to be placed directly on a conveyor.

■ Space saving design

Locating the robot controls on the horizontal beam reduces the amount of floor space required.

■ Simple to operate

Easy-to-use, compact, hand-held control has nine standard pre-programmed sequences and memory to save up to 90 additional programs. The control is a self-diagnostic system that displays error messages and alarms.

■ Accurate part placement

Programmable multiple release points on the horizontal axis enables the user to accurately position parts for additional applications downstream.



Remote adjustment*

Hand-held control improves safety and convenience by remotely adjusting vertical and kick stroke hard-stop positions.

Linear profile bearing system

Linear rail design assures axes travel stability throughout entire range of motion.

Cylinder safety lock

Prevents vertical arm drop if there is a sudden loss of air pressure.

Integrated control

Total footprint of the robot is reduced by integrating the controls into the horizontal beam.

R2 wrist rotation (optional)

Easily achieve accurate part placement and orientation with 90° or 180° pneumatic wrist rotation.

AC electric drive on horizontal axis

Flexibility with multiple stopping points on the horizontal axis.

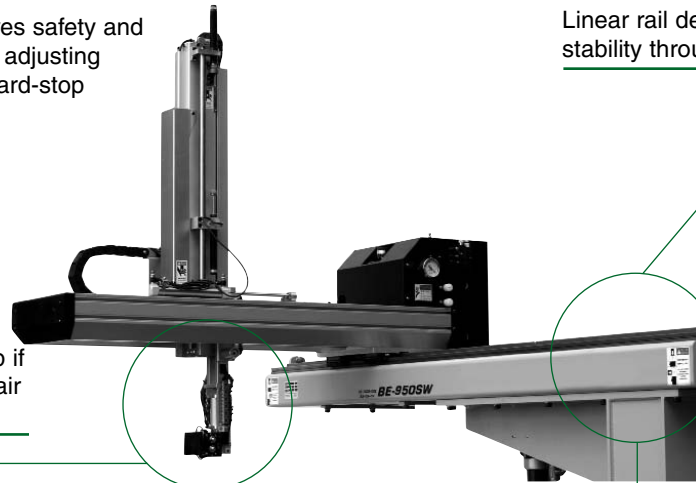
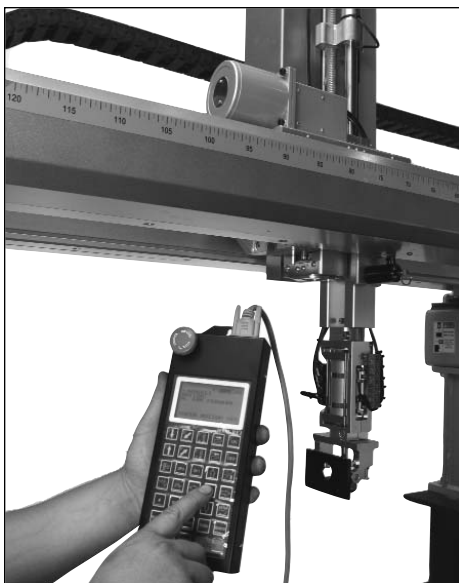
**HAND-HELD HSM CONTROL PENDANT****Control features**

- **Up to 99 programs saved** in memory for instant recall.
- **Self-diagnosis system** displaying error messages and alarms.
- **Standard conveyor indexing and palletizing features.**
- **Program up to 6 spare inputs and outputs** for end-of-arm tooling (EOAT), conveyor, etc.
- **Set and adjust cycle timers** in both manual and automatic mode.
- **Multiple stop programmability.**
- **Remote vertical and horizontal adjustments.***

*Remote vertical and horizontal adjustments on model 1100, 1300, 1500 and 1800 are standard. Remote adjustment is optional on model 950.

OPTIONS

- **Vacuum circuit** - Additional venturi vacuum grips can be added for applications that require parts to be released independent of one another.
- **Pressure circuit** - Additional pressure circuits can be added for applications that require parts to be released independent of one another.
- **Horizontal extensions** - Easy-to-add extensions provide flexibility to permit sizing of the robot to a specific application.
- **R2 rotation - 90° or 180°** - Optional R2 wrist rotation allows for the re-orienting of parts outside the molding machine to facilitate secondary operations.

WRIST ASSEMBLY WITH R2 OPTION
BE-950*

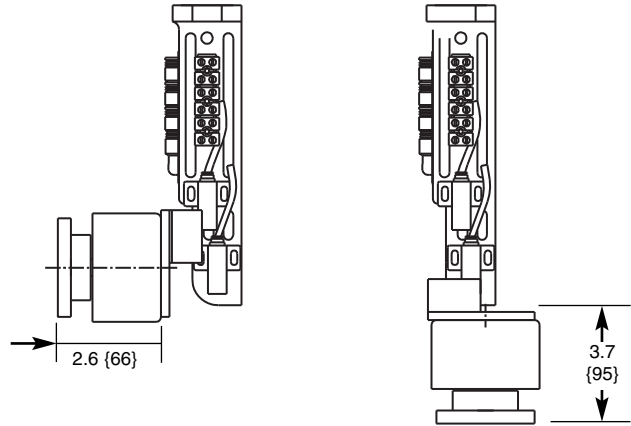

Note: Dimensions shown in inches and {mm}

SPECIFICATION NOTES:

*Wrist assembly with R2 option is shown on BE-950. Consult a Sepro America representative for wrist assembly specifications on BE models 1100, 1300, 1500 and 1800.

END-OF-ARM TOOLING MOUNTING PATTERNS

BE-950 AND BE-1100
END-OF-ARM TOOLING MOUNTING PATTERN

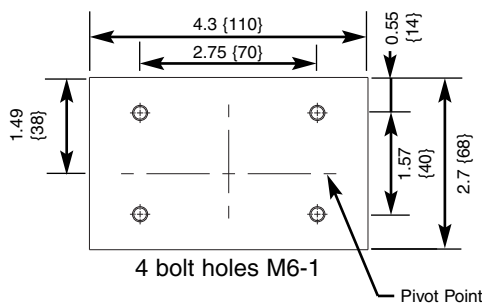

Note: Dimensions shown in inches and {mm}

BE-1300, BE-1500 AND BE-1800
END-OF-ARM TOOLING MOUNTING PATTERN

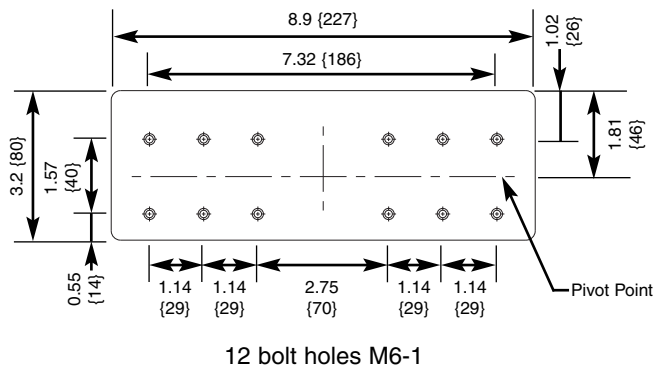

12 bolt holes M6-1

SPECIFICATIONS

BE MODELS

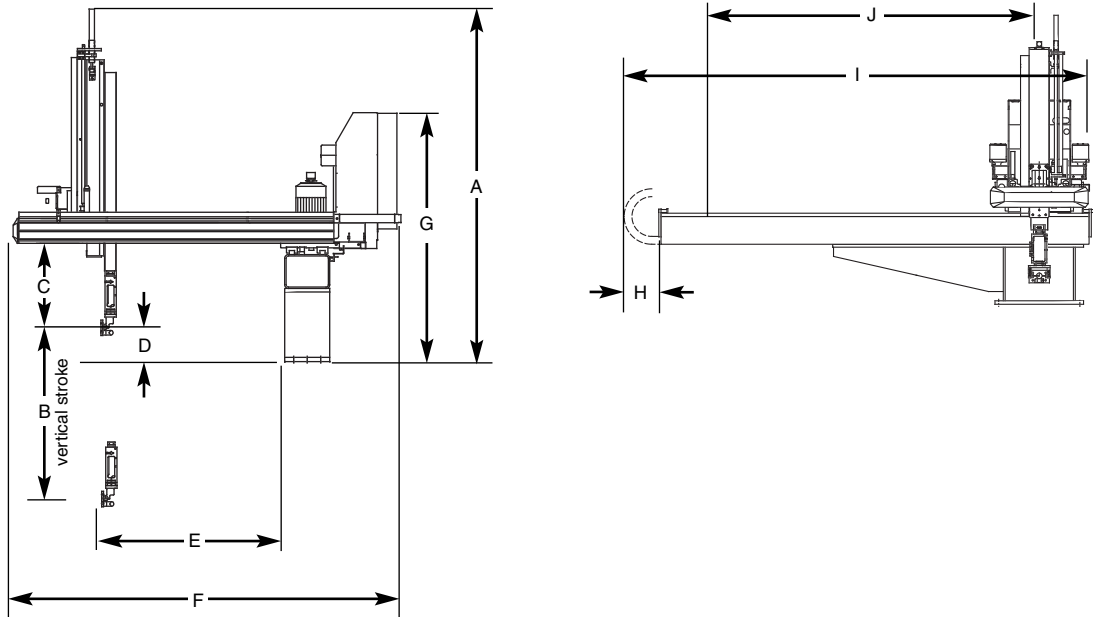

INSTALLATION DIMENSIONS inches {mm}

	A	B	C	D	E	F	G	H	I	J
BE-950	51.1 {1300}	37.4 {950}	9.8 {250}	6.7 {172}	7.8 {200}	49.6 {1260}	27.5 {700}	4.1 {105}	78.7 {2000}	56.7 {1440}
BE-1100	65.5 {1665}	43.3 {1100}	14.7 {375}	5.9 {150}	15.7 {400}	67.9 {1725}	43.5 {1105}	7.8 {200}	98.4 {2500}	78.7 {2000}
BE-1300	74.8 {1900}	51.1 {1300}	19.8 {505}	9.1 {230}	15.7 {400}	79.5 {2020}	52.0 {1320}	7.8 {200}	118.1 {3000}	88.5 {2250}
BE-1500	78.7 {2000}	59.0 {1500}	19.8 {505}	9.1 {230}	19.7 {500}	90.5 {2300}	52.0 {1320}	7.8 {200}	137.8 {3500}	108.2 {2750}
BE-1800	84.6 {2150}	70.1 {1800}	19.8 {505}	9.1 {230}	23.6 {600}	90.5 {2300}	52.0 {1320}	7.8 {200}	137.8 {3500}	108.2 {2750}

MODEL	BE-950	BE-1100	BE-1300	BE-1500	BE-1800
Performance characteristics					
Molding machine size	up to 350 ton	up to 450 ton	up to 550 ton	up to 650 ton	up to 850 ton
Maximum payload lb {kg}	6.6 {3}	17.6 {8}	44.0 {20}	44.0 {20}	44.0 {20}
Maximum payload with R2 option lb {kg}	5.0 {2.3}	Consult factory	Consult factory	Consult factory	Consult factory
Dimensions inches {mm}					
Strip stroke adjustment from face of platen (min-max)	9.8 - 25.6 {249 - 650}	11.3 - 36.0 {287 - 914}	11.8 - 51.1 {300 - 1300}	11.8 - 51.1 {300 - 1300}	11.8 - 51.1 {300 - 1300}
Main arm vertical stroke	37.4 {950}	43.3 {1100}	51.2 {1300}	59.1 {1500}	70.1 {1800}
Horizontal stroke	62.9 {1600}	78.7 {2000}	88.6 {2250}	108.3 {2750}	108.3 {2750}
Main arm strip stroke	5.9 {150}	15.7 {400}	15.7 {400}	19.7 {500}	23.6 {600}
Wrist flip (flop)	90°	90°	90°	90°	90°
Weight lb {kg}					
Installed weight	458 {208}	606 {275}	1399 {635}	1808 {820}	2138 {970}
Shipping weight	608 {276}	756 {343}	1549 {703}	1958 {888}	2288 {1038}
Electrical requirements					
AC 220V +/- 10%/3 phase/60 Hz					
Utility requirements					
Working air pressure psi {bar}	80 {5.5}	80 {5.5}	80 {5.5}	80 {5.5}	80 {5.5}
Maximum air pressure psi {bar}	130 {9.0}	130 {9.0}	130 {9.0}	130 {9.0}	130 {9.0}

SPECIFICATION NOTES:

Specifications may change without notice. Check with a Sepro America representative for the most current information.