

COMPRESSED AIR MATERIAL LOADERS

CAML-C Cyclone Loader

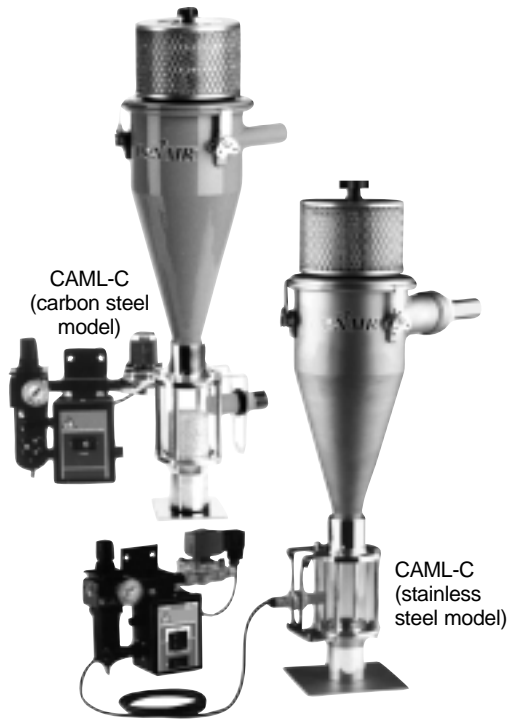

SIMPLE, QUIET CONVEYING; JUST-IN-TIME CONVENIENCE

Conair's Compressed Air Material Loaders (CAML) offer a quiet, simple alternative to noisy vacuum motors and complex central conveying systems. The direct feed discharge eliminates large material inventories at the machine throat.

You can select the standard carbon steel CAML-C or the stainless steel model for basic single-material conveying, or with a "Y" tube for ratio loading. Each CAML-C includes a mini-cyclone; viewing chamber; proximity demand sensor; control assembly with solenoid and air filter/regulator; and the Material Transfer Device (MTD).

Easy to use. No timers. No motors. No moving parts.

■ MINIMUM MAINTENANCE

No brushes to wear out. And because the loader body acts as a small cyclone separator, most dust is removed before it even reaches the filter.

■ MODULAR DESIGN

Modular design allows you to configure a CAML-C to meet the demands of your application. Select from a number of material pickup devices; viewing chamber and filter sizes; magnets; and alarm packages.

■ SIMPLE TO INSTALL

The CAML-C installs quickly on a machine throat or bin lid. Since the CAML-C uses positive pressure to convey material, you don't need a vacuum tight seal. Each unit comes with its own control, which can be mounted at eye level.

■ QUICK CLEAN OUT

Push-fit components and quick release latches on the loader lid make maintenance and material changes fast and easy.

How It Works:

When the sensor sees a demand for material, the CAML-C simply turns on the compressed air. A venturi-style Material Transfer Device (MTD) pushes the material into the loader. When the demand is satisfied, the CAML-C turns off the air.

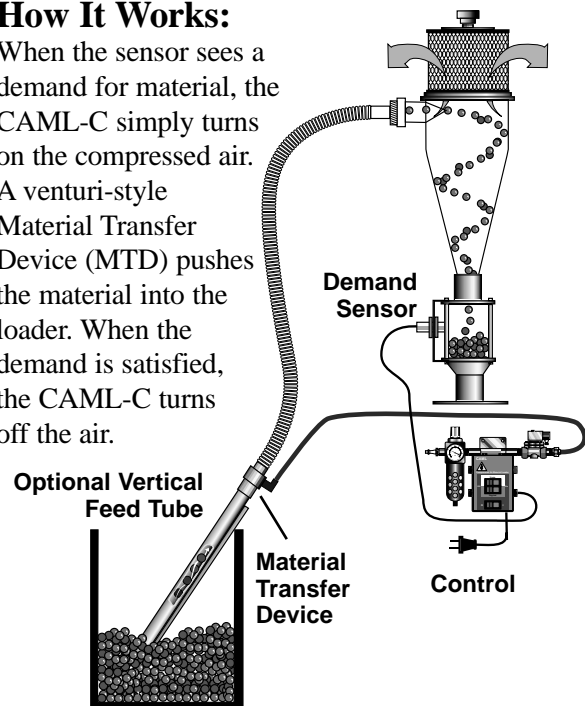

SPECIFICATIONS

**COMPRESSED AIR MATERIAL LOADERS
CAML-C Cyclone Loader**

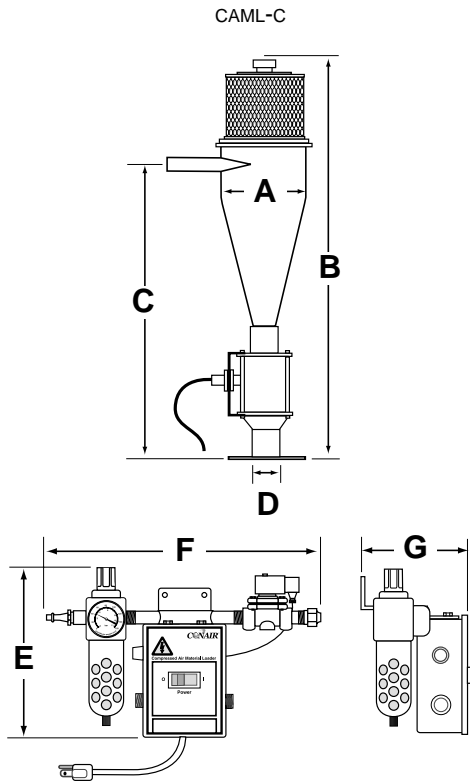

Mounting Plate
Specify 4 x 4 inches or 6 x 6 inches
{102 x 102 mm or 152 x 152 mm}

MODELS	CAML-C
Performance characteristics	
Maximum throughput lb/hr {kg/hr}	700 {318}
Recommended throughput * lb/hr {kg/hr}	400 {181}
Maximum conveying distance ft (m)	20 {6}
Loader Volume ft ³ {liters}†	0.1 {2.8}
Material line size in. {mm}	1.5 {38}
Dimensions inches {mm}	
A - Loader diameter	5.5 {140}
B - Height above mounting plate†	30.25 {768}
C - Height to center of material inlet†	21.5 {546}
D - Discharge hole diameter	1.75 {44}
E - Control height	8 {203}
F - Control width	10 {254}
G - Control depth	5 {127}
Weight lbs {kg}	
Installed	35 {16}
Shipping	40 {18}
Voltages Total amps	
120V/1 phase/60 hz	1
Compressed air requirements	
Consumption @ 60 psi ft ³ /min {liters/min}	8.25 {233.6}
NPT fitting	3/8 in.

SPECIFICATION NOTES

* Recommended throughputs ensure optimum performance and product life.

† Add 0.05 ft³ {1.3 liters} to volume and 6 in. {152 mm} to height for a 33 oz. viewing chamber.

Specifications can change without notice. Contact your Conair representative for the most current information.

OPTIONS

Material Pickup Devices



O-ring Adapters
Connect the Material Transfer Device to material lines with equal or larger outer diameters.

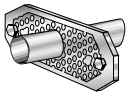

Horizontal Bin Tube
Install the Material Transfer Device on granulator trays, bins or other flat-walled storage containers.

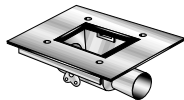

Micro Distribution Box
Install one or two Material Transfer Devices beneath a drying hopper or surge bin.



Vertical Feed Tube
Inserts into open material containers. Includes a coupling for the Material Transfer Device.

Dust Filter Options



High Capacity Filter
Choose the standard 6 ft² filter or the optional 14 ft² filter for regrind and dusty material.

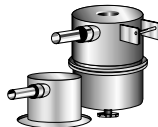

Remote Dust Filters
Remote filter kit with filter cap and dust collector for 14 ft² or 58 ft² filters.

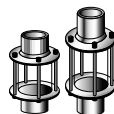

Viewing Chambers
Select standard aluminum 8 oz. or large 33 oz. Also available in stainless steel.

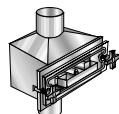

Drawer Magnet
Install below the viewing chamber discharge to catch tramp metal before it can enter the machine throat.

Ratio Intake Tube



For ratio loading of two materials.

Low Material Alarm



Audible/visual alarm lets you know when there is a material problem.

High Wear Kit

Prolong loader life with a wear plate bolted in to the receiver and an abrasion resistant Material Transfer Device.