



Model CE-1221
shown with optional
sheet feed

AFFORDABLE, RUGGED, GENERAL-USE GRANULATORS

Rugged CE Granulators can handle a broad range of materials, sprues, runners and parts.

Although inexpensive, the CE Series has many of the features found on our top-of-the-line granulators, including adjustable rotating knives, a flywheel-type pulley and D2 steel knives for long life.

The CE-1221 has a 12- by 24-inch cutting chamber and motor sizes from 15 to 50 Hp.

FOR MACHINE-SIDE OR CENTRAL GRANULATION

Our CE Granulators are small enough to put beside your processing machine, yet tough enough to handle central granulation jobs.

The CE-1221, with its eight-blade rotor, larger motor sizes, and an optional extra flywheel, has the cutting power to handle heavy-duty, thick-walled parts, pipe, profile and small purgings.

Other CE Series options include special hoppers for sheet and pipe, sound-controlled hoppers and vacuum or pneumatic evacuation systems.

■ Adjustable rotor knives

Adjustable knives allow the clearance between rotor knife, bed knives and screen to remain constant, eliminating screen clogging, minimizing heat buildup and reducing fines.

■ Scissor-cutting action

Slant knives have a scissor-cutting action for higher throughputs with less noise, dust, fines and energy consumption.

■ Safe, easy access

Hinged components provide easy access to the cutting chamber and screen area for blade adjustment and cleaning. Integral limit switches prevent accidental operation during servicing or clean out.

■ Flywheel type pulleys

Energy-efficient, flywheel-type pulleys increase rotor inertia, requiring less horsepower for maximum cutting force.

CE-1221 with standard feed hopper

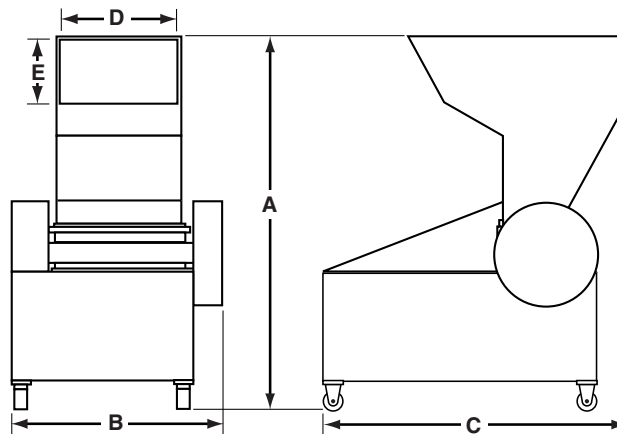

CE-1221 cutting chamber

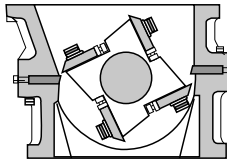

Standard open rotor

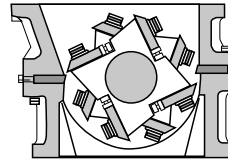

Optional staggered rotor

MODELS	CE-1221			
Performance characteristics				
Maximum throughput* lb/hr {kg/hr}	500 {226.8}			
Cutter chamber opening in. {mm}	12 x 24 {300 x 600}			
Rotor speed rpm	785			
Motor power† Hp {kW}	15 {11.2}			
Screen hole sizes	1/8, 1/4, 5/16, 3/8, 1/2, 5/8 and 1 in. {4, 6, 8, 10, 12 and 17 mm}			
Rotor				
Rotor type	open rotor (staggered rotor, optional)			
Number of rotating knives	8 adjustable			
Number of fixed knives	2			
Dimensions inches {mm}				
A - Height	72 {1830}			
B - Width	44.5 {1130}			
C - Depth	55 {1390}			
D - Feed hopper opening width	21.5 {540}			
E - Feed hopper opening height	12 {300}			
Weight lb {kg}				
Installed	2000 {907.2}			
Shipping	2200 {998}			
Voltages Total amps based on motor size				
Motor power	15 Hp	25 Hp	40 Hp	50 Hp
208V/3 phase/60 Hz	46.2	74.8	N/A	N/A
230V/3 phase/60 Hz	41.8	68.0	104.0	N/A
400V/3 phase/50 Hz	24.0	39.1	59.8	74.8
460V/3 phase/60 Hz	21.0	34.0	52.0	65.0
575V/3 phase/60 Hz	16.7	27.1	41.0	52.0
Noise level ‡				
With no soundproofing	90 - 100 dbA			

MOTOR OPTIONS		
●=standard	○=optional	CE-1221
5 Hp {3.7 kW}		N/A
7.5 Hp {5.6 kW}		N/A
10 Hp {7.5 kW}		N/A
15 Hp {11.2 kW}	●	
25 Hp {18.7 kW}	○	
40 Hp {29.8 kW}	○	
50 Hp {37.3 kW}	○	

SPECIFICATION NOTES:

* Throughputs are provided as a capacity guideline only. Throughput will vary according to the size, shape, thickness and properties of the material to be cut, as well as the desired size of the granulate. Consult Conair for a material test or help determining the correct granulator model for your application.

† The chart lists standard motor selections. Additional motor sizes are listed under Motor Options.

‡ Noise level will vary according to material type being processed and the granulator configuration. These ranges are based on tests using SPI standards.

Specifications may change without notice. Check with a Conair representative for the most current information.