

**CHS-810, CHS-814, CHS-819 AND CHS-824**

Model CHS-814S  
shown with optional base  
sound enclosure

# HIGH SPEED ROTOR FOR TOUGH BATCH FED JOBS

CHS Series of beside-the-machine granulators combine rugged, dependable performance with consistent, high-quality regrind.

The CHS is designed for batch fed parts and runners, and tough applications such as engineered materials and bulky or heavier cross section parts. These units are great for blow molded parts, sheet and film, small pipe, tubing and profile, as well as sprues and runners.

A high-inertia flywheel coupled with the staggered, cassette knife rotor provides higher throughput per hour at lower horsepower.

## QUIET, EFFICIENT PERFORMANCE

The CHS Series granulators are designed for custom molders who don't always know part shape or material. The CHS comes standard with a tangential cutter housing that allows the staggered rotor knives to engage the part on the down stroke, assuring fast, clean and effective size reduction. For applications that require less aggressive feeding, the CHS can be fitted with an optional third bed knife.

To further enhance versatility, the CHS comes with a front feed that accepts hand, robot or conveyor feeds and is available with an optional three-blade open rotor for lighter applications such as film, corrugated sheet and lightweight bottles.

CHS Series options also include: custom hoppers to handle a wide range of batch fed parts, soundproofing, wear resistance packages, blower systems, high level sensors and larger horsepower motors.

### ■ Clean, uniform granules

Adjustment-free constant cutting circle produces clean, consistent sized granulate with virtually no oversize and minimal fines. Bulk densities can be maintained close to virgin resin allowing for trouble-free blending and feeding.

### ■ Economical, disposable knives

Staggered rotor provides more cuts per revolution and a better 'bite' as compared to a single slant-knife, which makes it ideal for hard-to-cut parts. This rotor is also less prone to stall since only a 4.5 inch {11.4 mm} cutting surface is applied to the part at any time. Replacement blades are far more economical than regrinding, and drop-in without any adjustment.

### ■ Easy, no-tools access

No-tools access to the cutting chamber and a drop down screen cradle means you can perform a material/color changeover in five minutes or less.

### ■ Extended screen life

Standard screen is reversible to extend to life of your screen.



**SPECIFICATIONS**

**CHS-810, CHS-814, CHS-819 AND CHS-824**

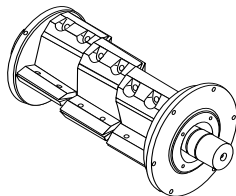
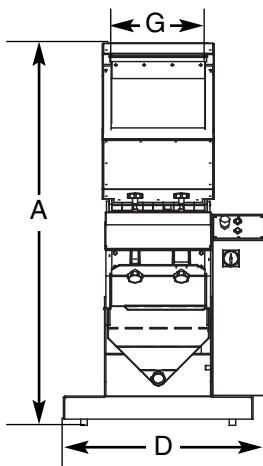
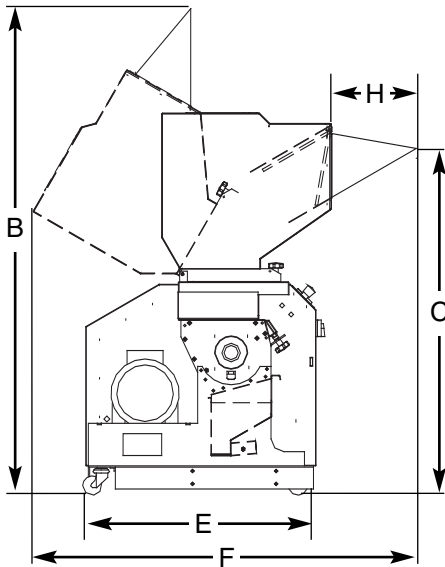

STANDARD STAGGERED ROTOR with disposable, cassette knives

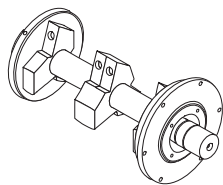

OPTIONAL OPEN ROTOR with scissor-cutting, slant knives

MODELS	CHS-810	CHS-814	CHS-819	CHS-824
<b>Performance characteristics</b>				
Throughput* lb/hr {kg/hr}	200 {90}	250 {115}	330 {150}	400 {180}
Cutter chamber opening in. {mm}	8.7 x 9.5 {220 x 240}	8.7 x 14.2 {220 x 360}	8.7 x 18.9 {220 x 480}	8.7 x 23.6 {220 x 600}
Rotor speed rpm	485	485	485	485
Cutting circle in. {mm}	7.88 {200}	7.88 {200}	7.88 {200}	7.88 {200}
Standard motor power Hp {kW}	5.0 {3.7}	7.5 {5.5}	7.5 {5.5}	7.5 {5.5}
Drive type	belt drive			
Hopper type	hand, robot, conveyor - standard (sheet, roll, profile, side feed - optional)			
Vacuum discharge side	front †			
Screen mesh sizes	5/32, 3/16, 1/4, 5/16, 3/8 in. {4, 5, 6, 8, 10 mm}			
Rotor type	staggered rotor - open rotor optional			
<b>Knives</b>				
Number of rotating knives (knives x segments)	3 X 2	3 X 3	3 X 4	3 X 5
Number of bed knives	2 (optional 3rd)	2 (optional 3rd)	2 (optional 3rd)	2 (optional 3rd)
<b>Dimensions inches {mm}</b>				
A - Height - hopper closed	58 {1480}	58 {1480}	58 {1480}	58 {1480}
B - Height - hopper open	73 {1856}	73 {1856}	73 {1856}	73 {1856}
C - Infeed height - floor to feed tray	53 {1346}	53 {1346}	53 {1346}	53 {1346}
D - Width	26 {670}	31 {790}	36 {910}	41 {1030}
E - Base depth	35 {890}	35 {890}	35 {890}	35 {890}
F - Overall depth	58 {1482}	58 {1482}	58 {1482}	58 {1482}
G - Feed hopper opening - width	9.5 {240}	14.0 {360}	19.0 {480}	24.0 {600}
H - Feed hopper opening - depth	8.6 {218}	8.6 {218}	8.6 {218}	8.6 {218}
<b>Weight lb {kg}</b>				
Installed	926 {420}	1014 {460}	1157 {525}	1257 {570}
Shipping	983 {446}	1058 {480}	1202 {545}	1301 {590}
<b>Voltages</b> Total amps based on standard motor				
208V/3 phase/60 Hz	17.5	24	24	24
230V/3 phase/60 Hz	15.2	22	22	22
460V/3 phase/60 Hz	7.6	11	11	11
575V/3 phase/60 Hz	6.1	9	9	9
<b>Noise level‡</b>				
Standard with hopper soundproofing	85-90 dbA			
Optional with hopper and base soundproofing	80-85 dbA			
Optional with no soundproofing	90-95 dbA			

**SPECIFICATION NOTES:**

\* Throughput is based on a 5/16 inch {8 mm} screen. Throughput rates are provided as a capacity guideline only. Throughput will vary according to size, shape, thickness and properties of the material to be cut, as well as the desired size of the granulate. Consult Conair sales for a material test or help determining the correct granulator model for your application.

† CHS granulators ordered with the optional base sound enclosure will have a rear discharge.

‡ Noise level will vary according to material type being processed and the granulator configuration. These ranges are based on tests using SPI standards.

Specifications may change without notice. Check with a Conair representative for the most current information.

**OPTIONS**

- Discharge: manual, vacuum (standard), blower
- Base sound enclosure
- Hardened cutter housing
- Third bed knife
- 3-blade open rotor
- Nitro-carburized screen

	MOTOR OPTIONS ●=standard ○=optional			
	CHS-810	CHS-814	CHS-819	CHS-824
5 Hp {4 kW}	●	N/A	N/A	N/A
7.5 Hp {5.5 kW}	○	●	●	●
10 Hp {7.5 kW}	○	○	○	○
15 Hp {11 kW}	○	○	○	○

